

Thank you very much for choosing Umbrella Company / Fusion Blender. Please read this instruction manual thoroughly before use in order to use this product properly.

About Fusion Blender

Fusion Blender is DUAL channel blender pedal with Filters. "Clean Sound Blend(Mix) " when only one pedal is connected and "Parallel Mix" when two pedals are connected to both Send and Return. Also powerful High-Pass / Low Pass filters for each channel, each pedals (or direct/clean sound) can be "mixed with High-Pass and Low-Pass Filters".

It is a professional tool which can dramatically increase the possibility of guitarist, bassist's sound make-up.

Functions

Connections

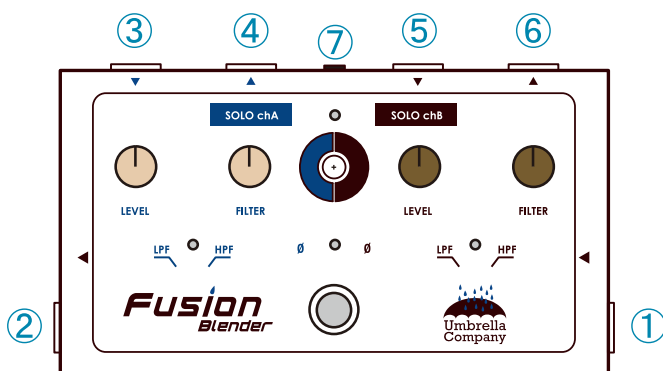

- ① **INPUT** - Input Connector
- ② **OUTPUT** - Output Connector
- ③⑤ **RETURN** - Connect signal from external pedal.
- ④⑥ **SEND** - The input signal is properly distributed by buffer and output.
- ⑦ **POWER** - Power input terminal. DC 9 V (Negative tip) .Please use with a power supply that can supply 100 mA or more. Only for proper power adapter.

* With the plug not connected to the RETURN connector, Buffered direct sound is routed.

Panel Control

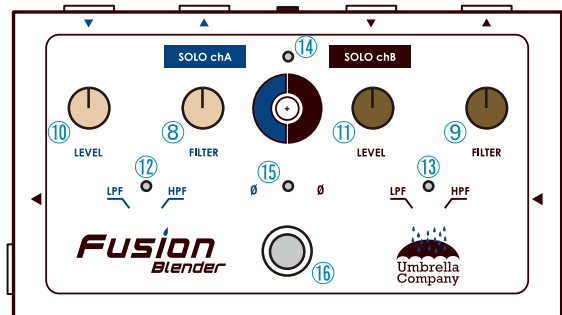

- ⑧⑨ **Filter Knob** - Adjust cutoff frequency of the filter. It becomes 20 kHz in fully clockwise position, 60 Hz in fully counter-clockwise direction. If you need FLAT response (no affect with filter), Select LPF position and turning Filter knob fully clockwise.

*Please note, Depending on the position of the Filter knob, the volume will be difference . It might increase the volume when you switch the LP / HP switch.

- ⑩⑪ **Level Knob** - Adjust the volume of each channel. It has a gain of + 6 dB at the maximum.

- ⑫⑬ **LPF/HPF Switch** - Switch Low-Pass and High-Pass filter.

· LPF (Low Pass Filter) - Extract low frequency. Also, you can say paraphrase with high cut filter.

· HP (High Pass Filter) - Extract high frequency. Also, you can say paraphrase with low cut filter.

LPF is selected and turning the filter fully clockwise, it becomes a flat characteristic covering the whole audible band, so it is practically equivalent to the state where the filter is turned off.

- ⑭ **Solo chA/B Switch** - You can listen the solo sound of channel A or B by turn the toggle switch to right or left. Center position is "Fusion(Mix) sound, mixing channels both A and B.

⑮ ϕ - It is a phase switch. Reverses the phase of the selected side channel. Center position is positive Phase. Some wah, distortion, some compressors, they are output phases in opposite phases when the effect is ON. Please try the phase switch when you feel un-natural sounding ,volume goes down or low frequency disappears when Fusion(mix) the sound.

- ⑯ **Foot Switch** - Bypass switch. It is a true bypass circuit using relays. The LEDs will light when engaged.

How to use Fusion Blender

1, Mix two overdrive pedals

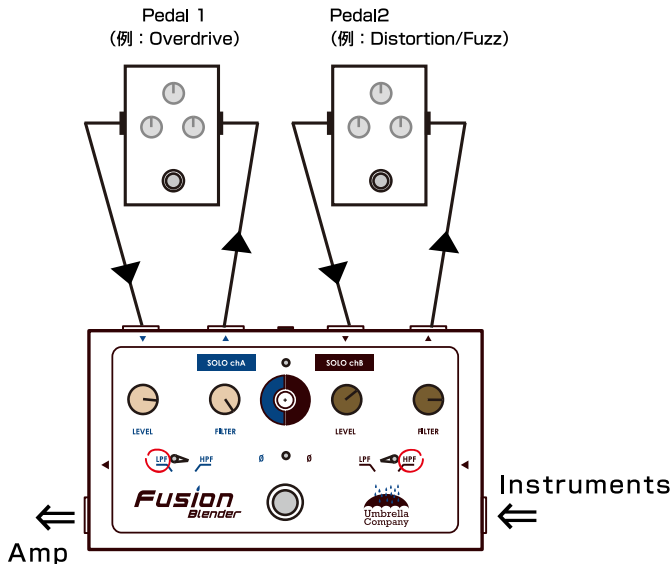

This example is FUSION(Parallel Mix/Blend) by connecting mild overdrive to channel A. Also edgy distortion (or fuzz) with on channel B. On the chB side, use FILTER to extract only the high frequency of the distortion sound (FILTER set on the HPF side). By setting the filter to turn to the LPF side and the FILTER knob to the clockwise side on the chA side, You can create more 3D dimensional drive sound. It is completely different from the case where two pedal.

2, Clean Mix(Original sound blend)

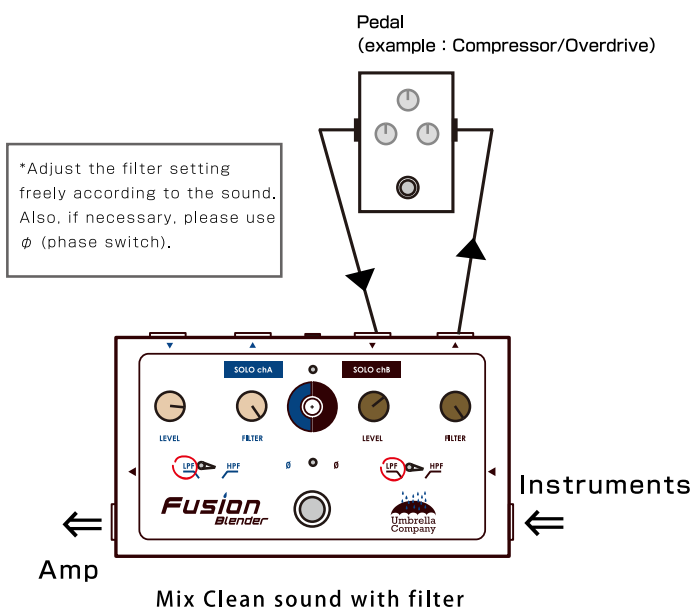

When no plug is inserted in the RETURN jack, the buffered direct/clean sound is mixed to output. For example, if you do not connect anything to ch A and connect a compressor pedal to ch B, you can blend the original clean sound into the compression sound. Result, produce a lively compressed sound. Sometime (example MXR Dynacomp) pedal output's phase may be opposite. If you mix or blend(Fusion!) and the volume dropped down, or if the low range becomes un-natural, Activate the ϕ (phase) switch to invert the phase.

If you connect the overdrive/distortion pedal to one of the channel, you can reproduce the sound of "double potentiometer" that distorted sound and original/clean sound are blended like a famous Centaur pedal.

3, Buffered Bypass

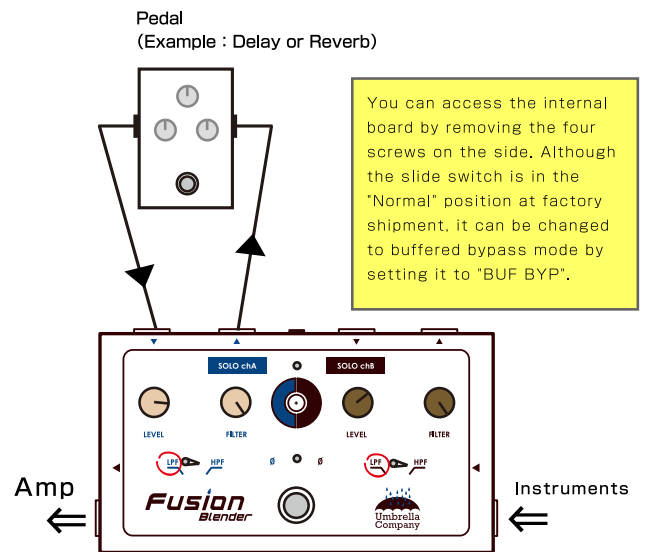

By switching the internal slide switch, it can be used in buffered bypass mode. In buffered bypass mode, only chA is turned ON / OFF. ch B is output regardless of the bypass switch.

Material A ON / OFF controls the SEND signal, so it can be applied to how to leave the reverb/delay tails.

Moreover, it can also be applied to usage such as "chB sound for Backing track only, And chA+chB when you play Solo.

Output Impedance Jumper

Considering the compatibility with fuzz or distortion pedals, the output impedance of the Send jack is designed high impedance. Replace the jumper on the internal board and set the output impedance By setting to [LO] side, it is also possible to use the studio equipment with your pedal board setting.

